

TAV 4

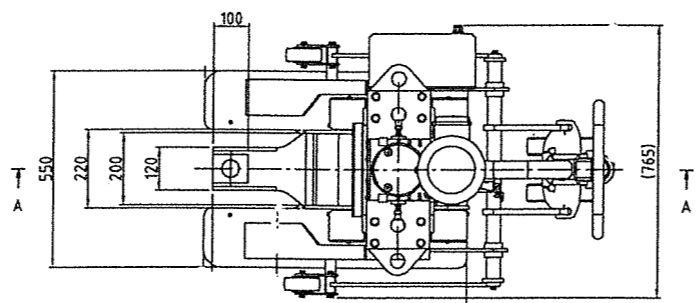

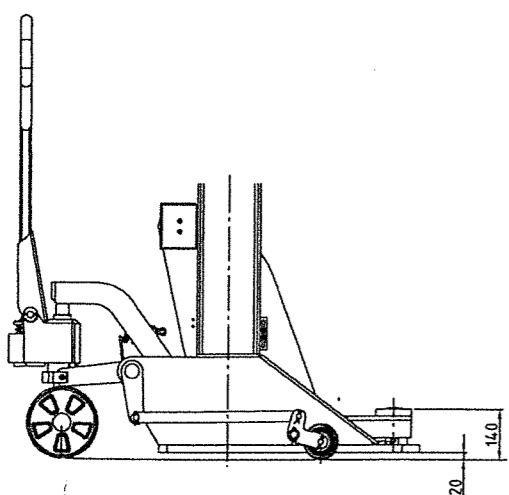

TAV2

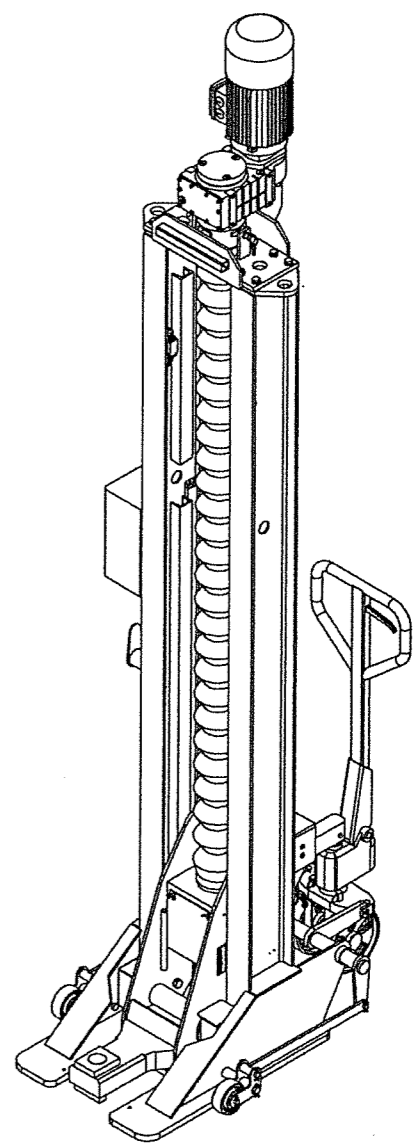
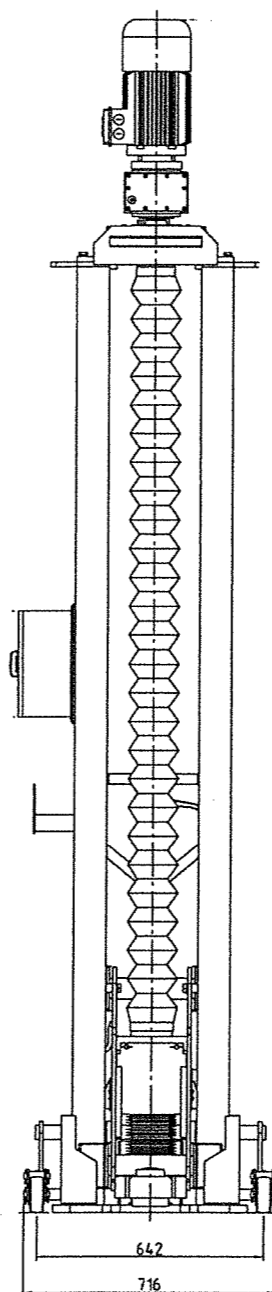
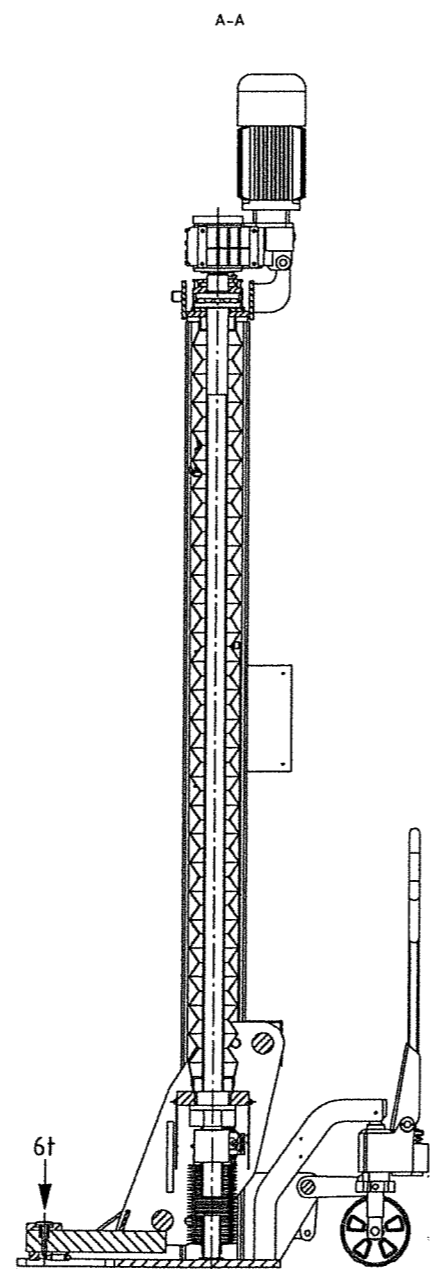
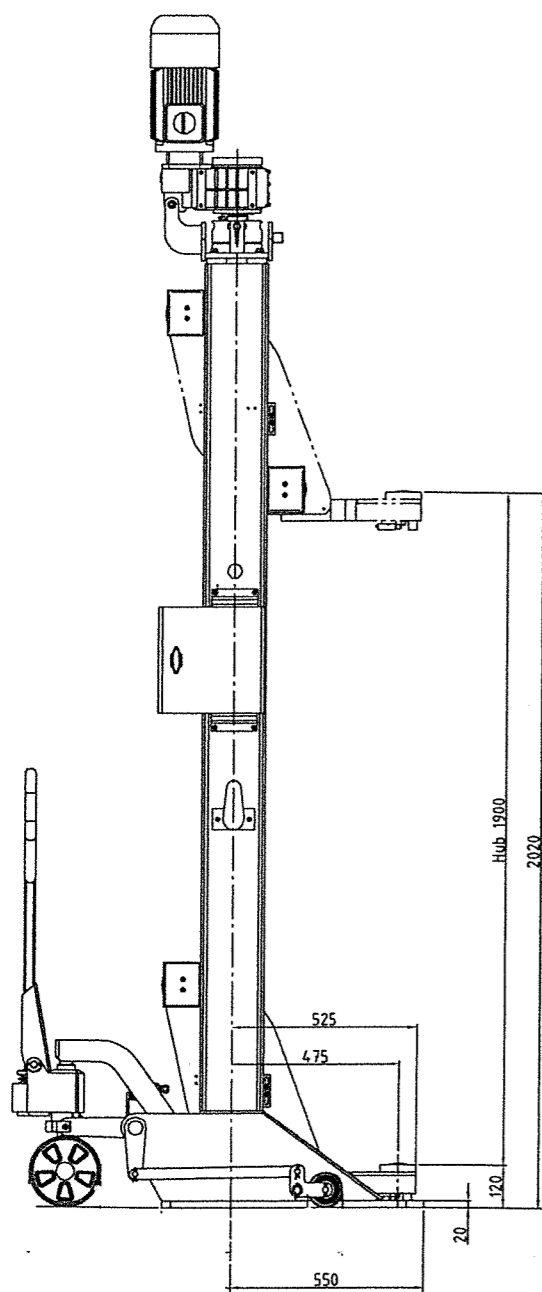
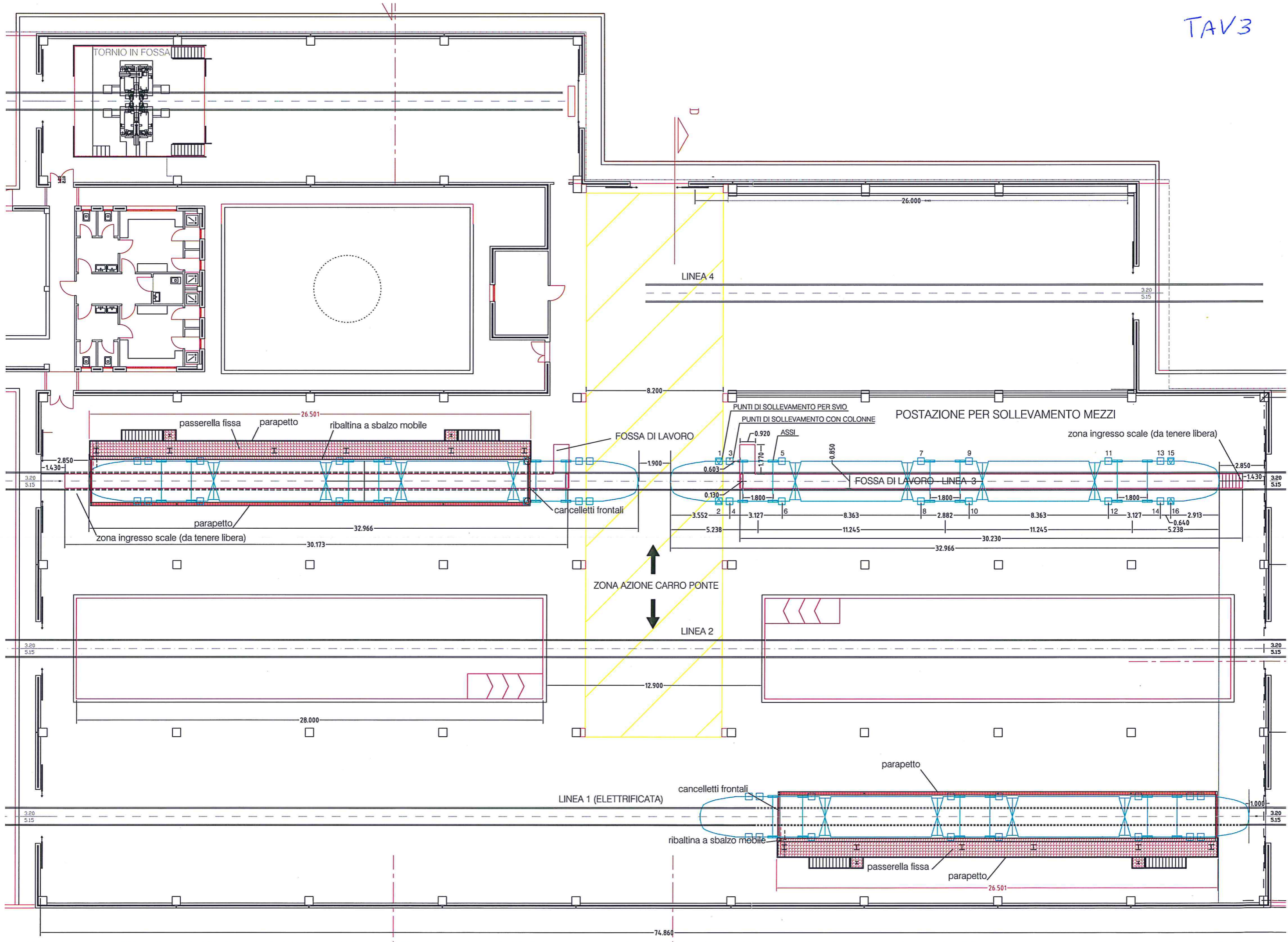
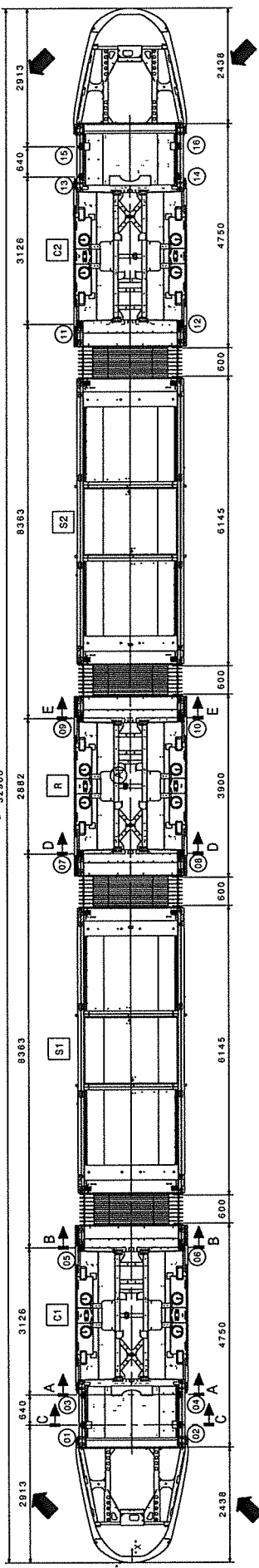
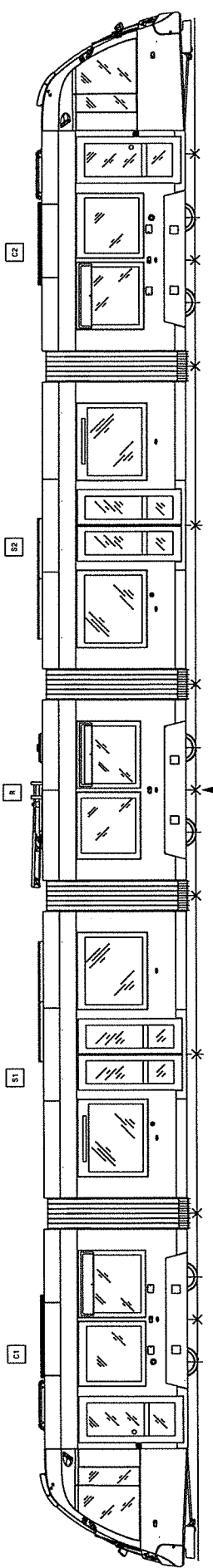

A-A / C-C
1:15

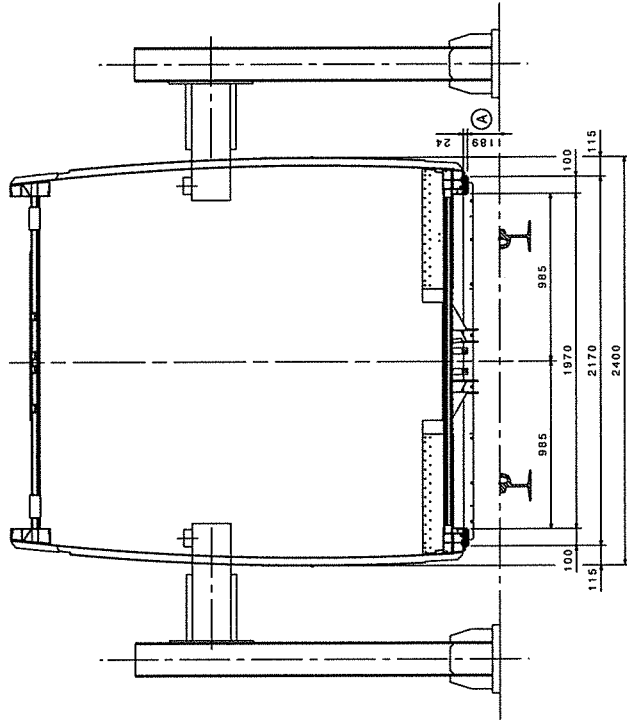

B-B / D-D / E-E
1:15

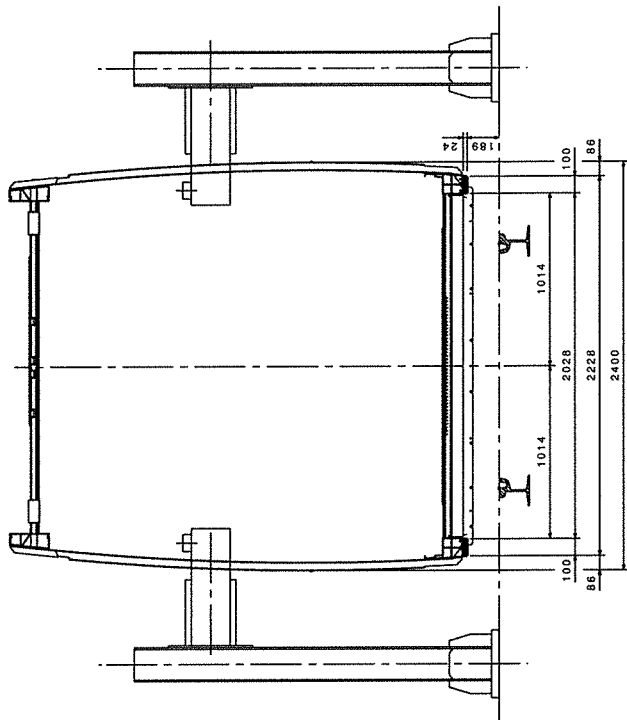

TAV2		325866	325866	325866	325866	325866	325866
LIFTING AND RECALLMENT POINTS							
Q.48.97.105							
B 1/1							

Small text at the bottom right corner, likely a disclaimer or copyright notice.

Senza la nostra espressa autorizzazione, queda terminantemente proibida la riproduzione total o parcial de este documento, asi como su uso indebido y/o su exhibicion o comunicacion a terceros. De los infractores se exigira el correspondiente resarcimiento de danos y perjuicios. Quedan reservados todos los derechos inherentes, en especial los de patentes, de modelos registrados y esteticos.

Senza la nostra espressa autorizzazione, rimane terminantemente proibita la riproduzione totale o parziale di questo documento, come il suo uso indebito y/o la sua esibizione o comunicazione a terzi. Dei trasgressori si esigera il corrispondente risarcimento di danni. Fungono riservati tutti i diritti inerenti, specialmente quelli di brevetti, di modelli registrati ed estetici.

1 PUNTOS DE LEVANTE DE LA UNIDAD COMPLETA CON BOGIES: 03,04,05,06,07,08,09,10,11,12,13, 14.
PUNTI DI RIALZO DELL'UNITA COMPLETA CON CARELLI: 03,04,05,06,07,08,09,10,11,12,13, 14.

2 PUNTOS DE ENCARRILO: 01,02,03,04,07,08,09,10,13,14,15,16.
PUNTI DI RIMESSA SUL BINARIO: 01,02,03,04,07,08,09,10,13,14,15,16.

PUNTOS DE LEVANTE / PUNTI DI RIALZO	"X" [mm]	"Y" [mm]	"Z" [mm]
EXTREMO TRAMPILLA ENGANCHE / FINE BOTOLA AGGANCIO	0	0	N/A
1	2913	1035	189
2	2913	-1035	189
3	3553	1035	189
4	3553	-1035	189
5	6679	1064	189
6	6679	-1064	189
7	15042	1064	189
8	15042	-1064	189
9	17924	1064	189
10	17924	-1064	189
11	26287	1064	189
12	26287	-1064	189
13	29413	1035	189
14	29413	-1035	189
15	30053	1035	189
16	30053	-1035	189
EXTREMO TRAMPILLA ENGANCHE / FINE BOTOLA AGGANCIO	32966	0	N/A



B Revision notification: 2346-00082 04-28 25140
B Notificazione di Revisione: 2346-00082 04-28 25140

PUNTI RIALZO		P	
PUNTOS DE LEVANTE		P	Q.48.97.105
Preparato	2015-02-12	23242	
Verificato	2015-02-09	25140	
Approvato	2015-02-09	25094	
Date			it/en p/n: 2 / 2

CONSTRUCCIONES Y AUXILIAR DE FERROCARRILES, S.A.



Allegato n° 1

